



# ROCKER SWITCH

## Model Information

KCD 5 - 1 02 (E) (N) (L) - 2 C3 - R / B

- Base color
- Cap color
- Cap marking
- Product Number
- Bent terminals
- Illuminated
- Dot
- Circuit function
- Poles
- Miniature type
- Rocker Switch

## Specification

1. Rating: ( ) 6A 125VAC; 3A 250VAC
2. Contact Resistance: 35mΩ max
3. Insulation Resistance: 500VDC 100mΩ min
4. Dielectric Strength: 1500VAC, 1minute
5. Operating Temperature: -25°C ~ +85°C
6. Electrical Life: 10'000 Cycles

## Circuit function

01	ON	-	OFF
02	ON	-	ON
11	(ON)		OFF
12	ON	-	(ON)
03	ON	OFF	ON
13	ON	OFF	(ON)
23	(ON)	OFF	(ON)

( ) Indicates Momentary

## Cap marking

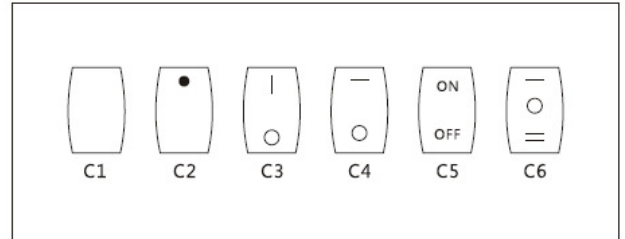

KCD5-101 ON-OFF

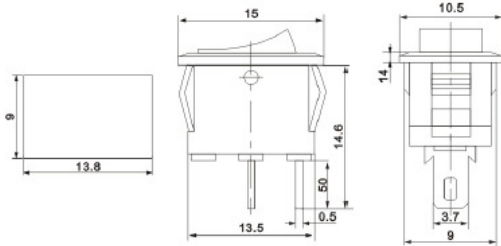

KCD5-303

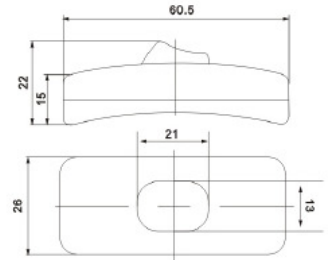

KCD5-102 ON-ON  
KCD5-101/N ON-OFF

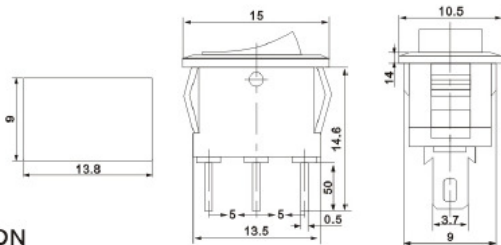

KCD5-304

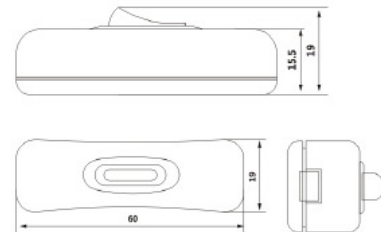

KCD5-101-2 ON-OFF  
KCD5-102-2 ON-ON  
KCD5-101N-2 ON-OFF

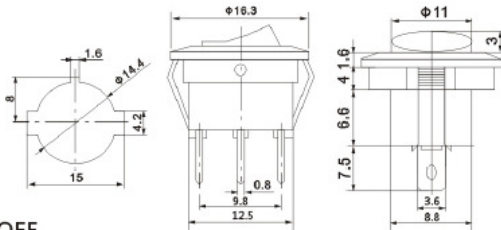

KCD5-305

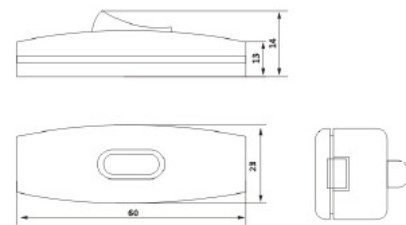

KCD5-102-3 ON-ON

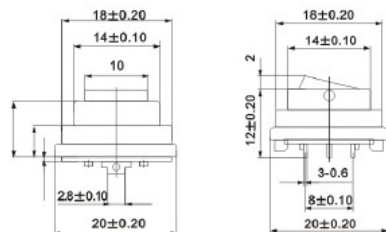

KCD5-322

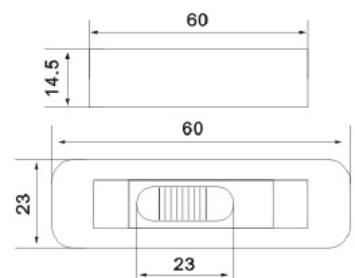



# ROCKER SWITCH

## Model Information

KCD 1 - 1 02 (E) (N) (L) - 2 C3 - R / B

- Base color
- Cap color
- Cap marking
- Product Number
- Bent terminals
- Neon lamp
- Dot
- Circuit function
- Poles
- Sub-Miniature type
- Rocker Switch

## Specification

1. Rating: ( )6A 125VAC; 3A 250VAC
2. Contact Resistance:35mΩ max
3. Insulation Resistance:500VDC 100mΩ min
4. Dielectric Strength:1500VAC, 1minute
5. Operating Temperature:-25°C~+85°C
6. Electrical Life:10'000 Cycles







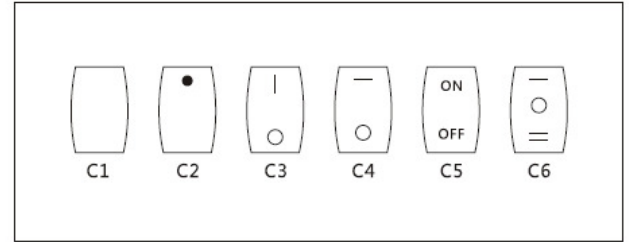

## Circuit function

01	ON	-	OFF
02	ON	-	ON
11	(ON)	-	OFF
12	ON	-	(ON)
03	ON	OFF	ON
13	ON	OFF	(ON)
22	OFF	ON	ON
23	(ON)	OFF	(ON)

( ) Indicates Momentary

## Cap marking



 <p><b>KCD1-101 ON-OFF</b></p>	 <p><b>KCD1-101N-2 ON-OFF (单复位)</b></p>
 <p><b>KCD1-102 ON-ON</b></p>	 <p><b>KCD1-101N-2</b></p>
 <p><b>KCD1-101-1 ON-OFF</b> <b>KCD1-102-1 ON-ON</b></p>	 <p><b>KCD1-103-2 ON-OFF-ON</b> <b>KCD1-123-2 (ON)-OFF-(ON) (双复位)</b></p>
 <p><b>KCD1-101L-2 ON-OFF</b> <b>KCD1-102L-2 ON-ON</b> <b>KCD1-103L-2 ON-OFF-ON</b></p>	 <p><b>KCD1-101N-3 ON-OFF</b></p>

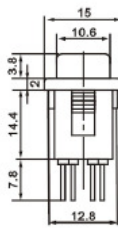
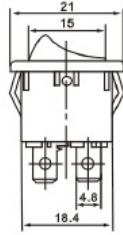
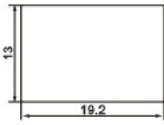

KCD1-201-4 ON-OFF

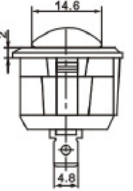
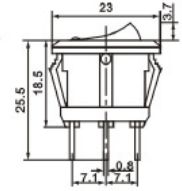
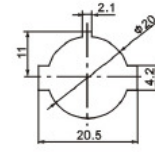

KCD1-101EN-5 ON-OFF

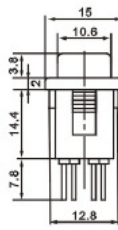
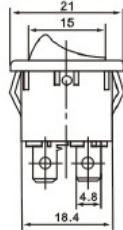
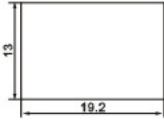

KCD1-201N-4 ON-OFF

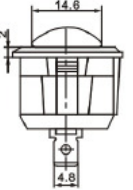
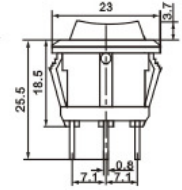
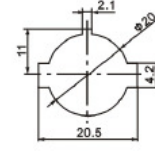

KCD1-103-5 ON-OFF-ON

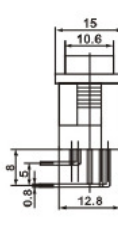
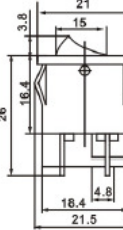
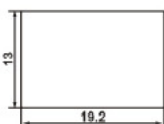

KCD1-201L-4 ON-OFF

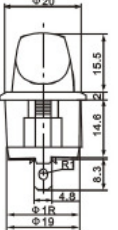
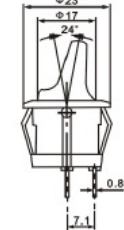
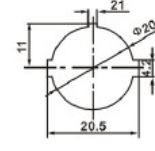

KCD1-101-5H ON-OFF

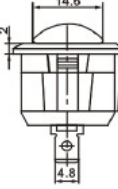
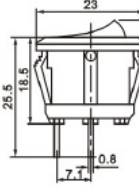
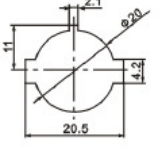

KCD1-101-5 ON-OFF

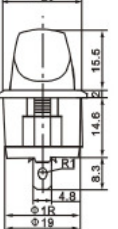
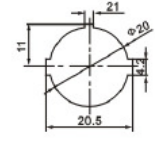

KCD1-102-5H ON-ON  
 KCD1-101N-5H ON-OFF  
 KCD1-103-5H ON-OFF-ON

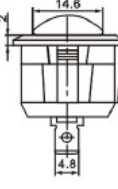
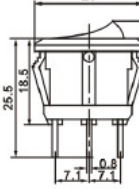
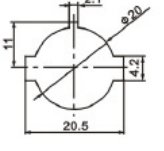

KCD1-102-5 ON-ON

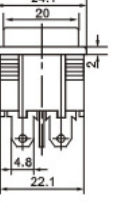
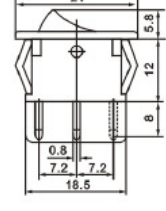
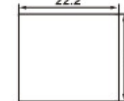

KCD1-201-6 ON-OFF  
 KCD1-201N-6 ON-OFF  
 KCD1-202-6 ON-OFF  
 KCD1-202N-6 ON-ON  
 KCD1-203-6 ON-OFF-ON

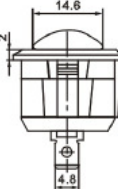
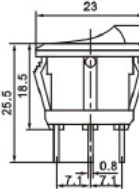
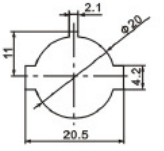

KCD1-101N-5 ON-OFF

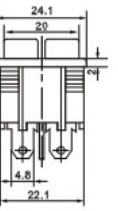
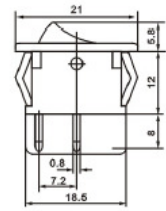
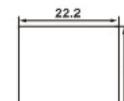

KCD1-2101-6 ON-OFF

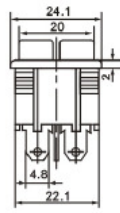
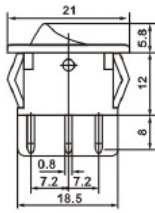
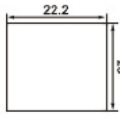

KCD1-2102-6 ON-ON

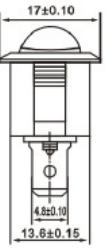
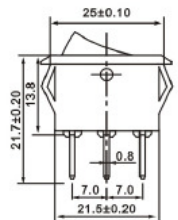
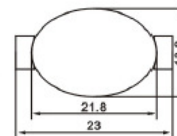

KCD1-102-9 ON-ON  
 KCD1-101N-9 ON-OFF

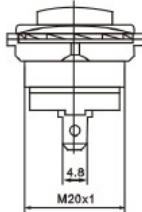
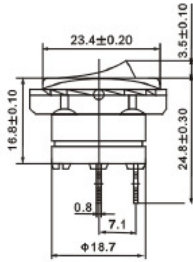

KCD1-101N-7 ON-OFF

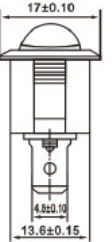
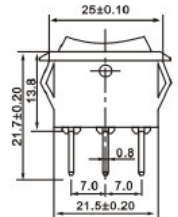
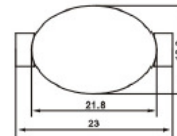

KCD1-103-9 ON-OFF-ON

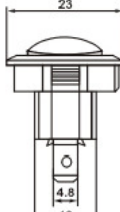
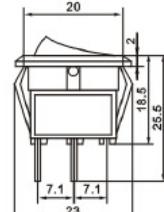
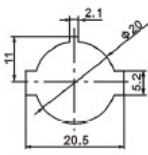

KCD1-101-8 ON-OFF  
 KCD1-102-8 ON-ON

KCD1-103-8 ON-OFF-ON

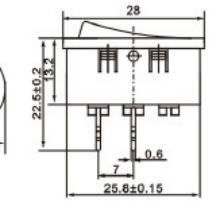
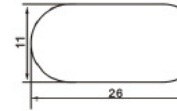

KCD1-101-10 ON-OFF  
 KCD1-102-10 ON-ON

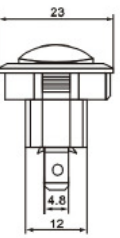
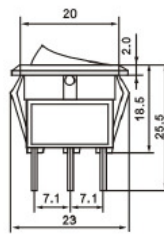
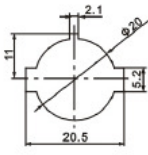

KCD1-101N-8

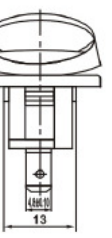
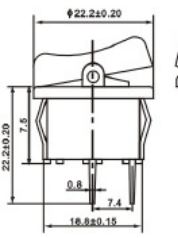
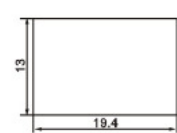

KCD1-101-11

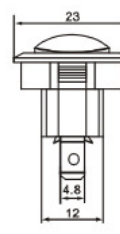
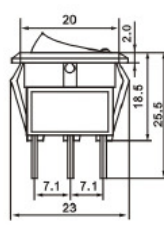
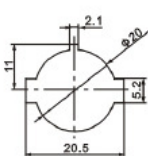

KCD1-101EN-8 ON-OFF

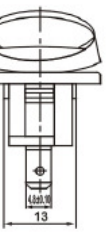
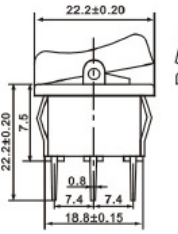
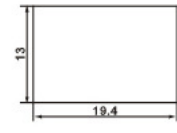

KCD1-102-11 KCD1-103-11

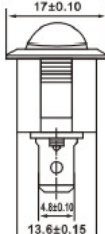
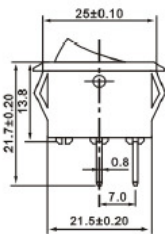
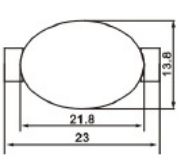

KCD1-101-9 ON-OFF

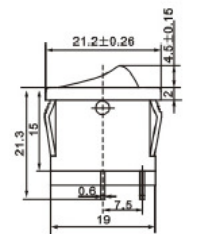
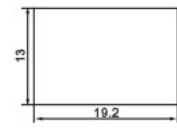

KCD1-201-1 ON-OFF



**ROCKER SWITCH**

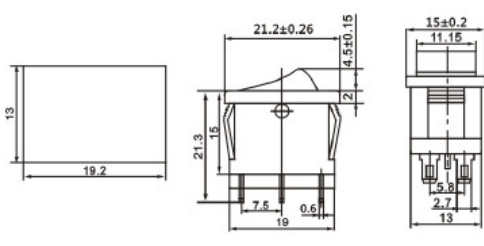

KCD1-202-1 ON-ON

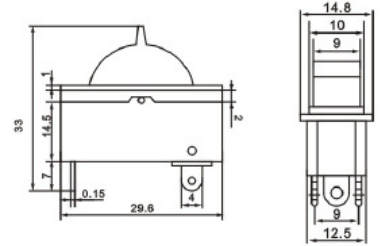

KCD1-122-2 OFF-ON-ON

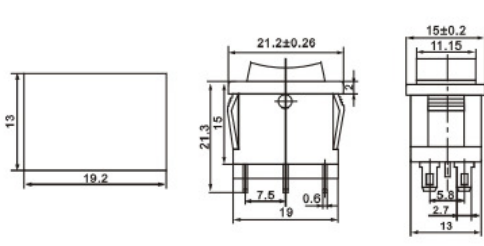

KCD1-203-1 ON-OFF-ON

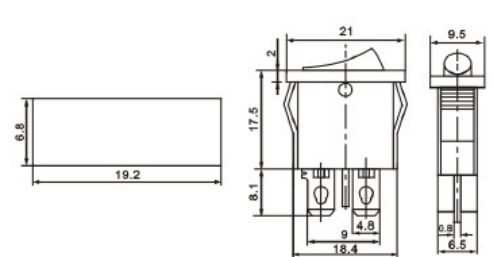

KCD1-101-12 ON-OFF

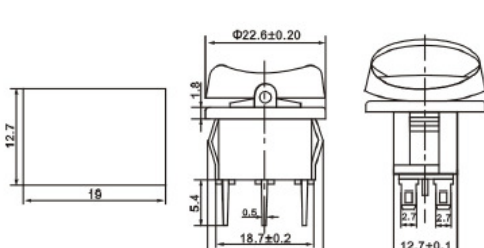

KCD1-202-1R ON-ON  
KCD1-203-1R ON-OFF-ON

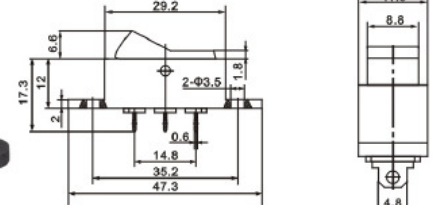

KCD1-102-13 ON-ON

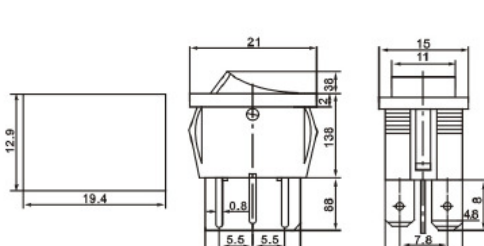

KCD1-201-2 ON-OFF  
KCD1-202-2 ON-OFF  
KCD1-203-2 ON-OFF-ON

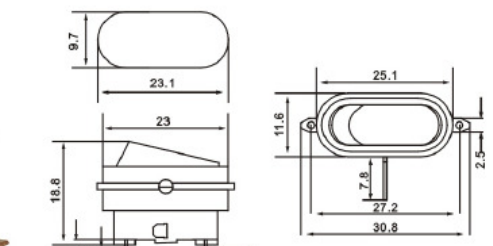

KCD3-101-14 ON-OFF

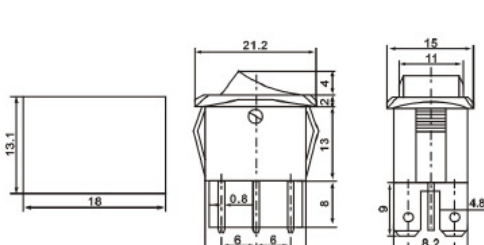

KCD1-201-3 ON-OFF  
KCD1-202-3 ON-ON  
KCD1-203-3 ON-OFF-ON

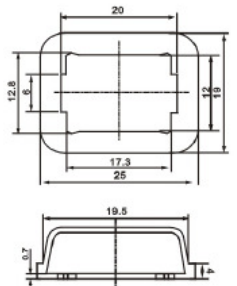

WPC-01  
Waterproof Cover

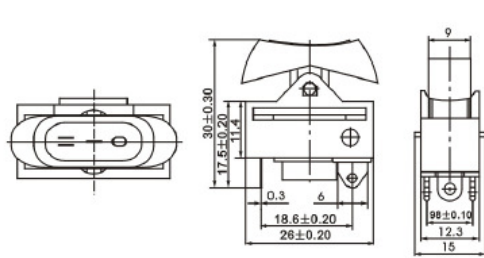

KCD1-122-1 OFF-ON-ON

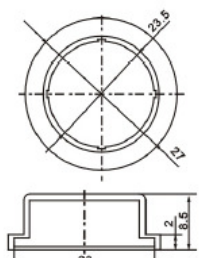

WPC-02  
Waterproof Cover

**Model Information**

KCD 3 - 1 02 (E) (N) - 2 C7 - R / B

- Base color
- Cap color
- Cap marking
- Product Number
- Neon lamp
- Dot
- Circuit function
- Poles
- Middle type
- Rocker Switch

**Specification**

1. Rating: 20A 125VAC; 15A 250VAC; 35A 12VDC
2. Contact Resistance: 35mΩ max
3. Insulation Resistance: 500VDC 100mΩ min
4. Dielectric Strength: 1500VAC, 1minute
5. Operating Temperature: -25°C ~ +85°C
6. Electrical Life: 10'000 Cycles

**Circuit function**

01	ON	-	OFF
02	ON	-	ON
11	(ON)		OFF
12	ON	-	(ON)
03	ON	OFF	ON
13	ON	OFF	(ON)
23	(ON)	OFF	(ON)

( ) Indicates Momentary

**Cap marking**

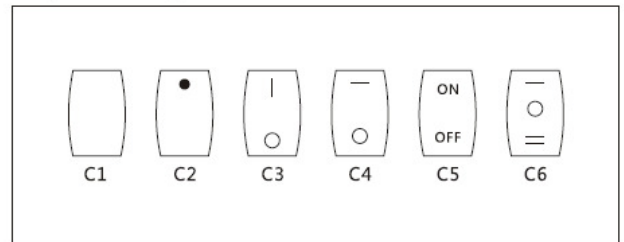

<p>KCD3-101 ON-OFF    KCD3-111 (ON)-OFF</p>	<p>KCD3-101-2 ON-OFF</p>
<p>KCD3-102 ON-ON    KCD3-102N ON-OFF</p>	<p>KCD3-101N-2V ON-OFF</p>
<p>KCD3-101EN ON-OFF</p>	<p>KCD3-101N-2C ON-OFF</p>
<p>KCD1-103 ON-OFF-ON</p>	<p>KCD3-101EN-2 ON-OFF</p>

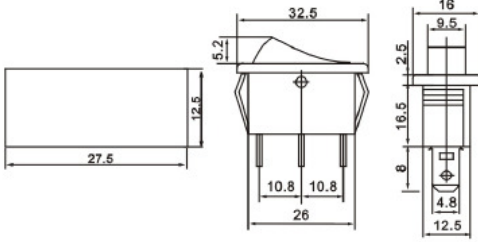

KCD3-101N-3 ON-OFF

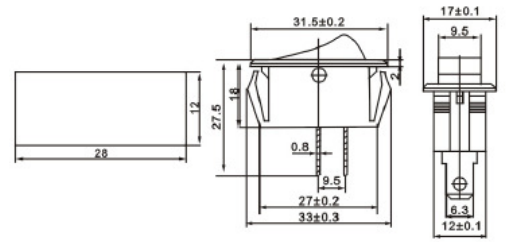

KCD3-101-7 ON-OFF

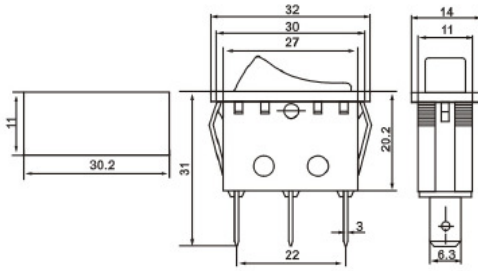

KCD3-101-4

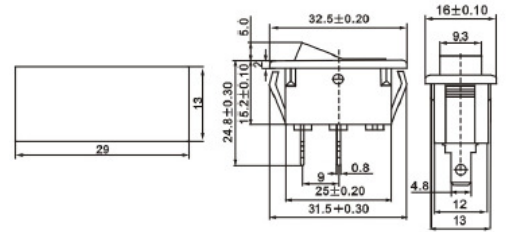

KCD3-101-8 ON-OFF

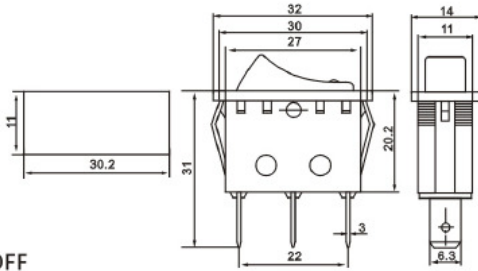

KCD3-101N-4 ON-OFF  
KCD3-101EN-4 ON-OFF

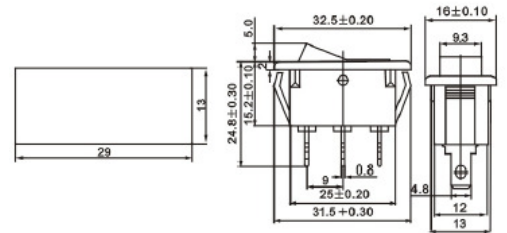

KCD3-102-8 ON-ON

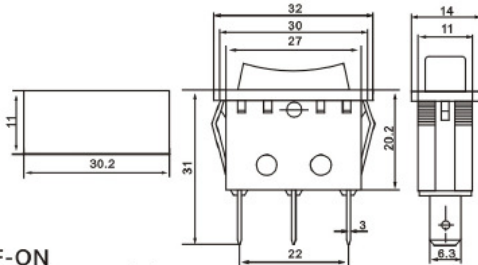

KCD3-103-4 ON-OFF-ON  
KCD3-123-4 (ON)-OFF-(ON) (双复位)

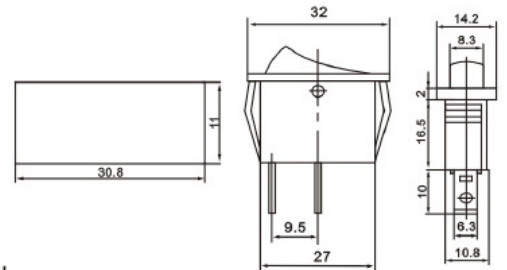

KCD3-102-9 ON-ON

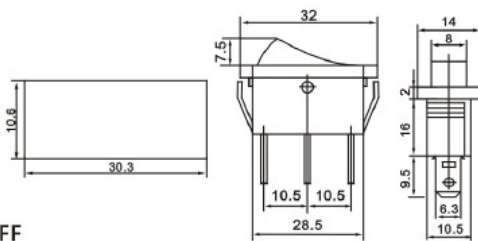

KCD3-101N-5 ON-OFF  
KCD3-102-5 ON-ON  
KCD3-103-5 ON-OFF-ON

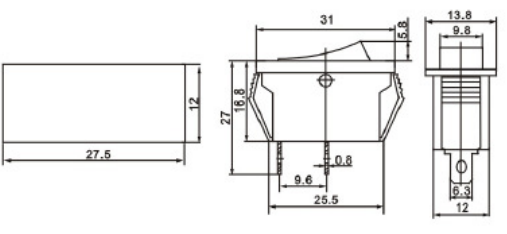

KCD3-101-10 ON-OFF

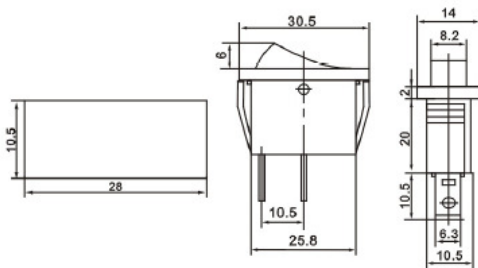

KCD3-101-6 ON-OFF

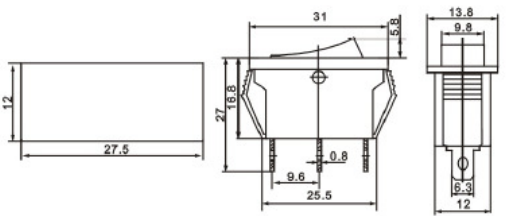

KCD3-102-10 ON-ON  
KCD3-103-10 ON-OFF-ON



KCD3-101N-11 ON-OFF

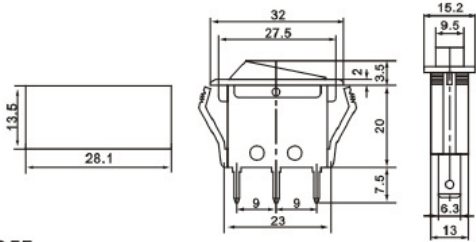

KCD3-201N-14P ON-OFF

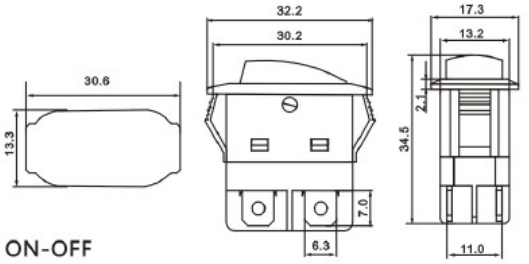

KCD3-201-11A ON-OFF  
DPST 4P

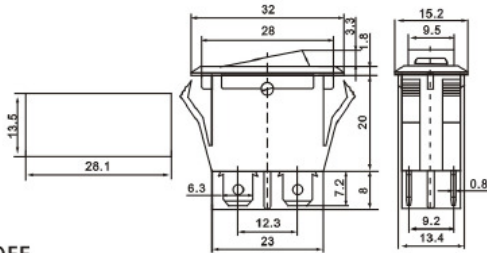

KCD3-101-15

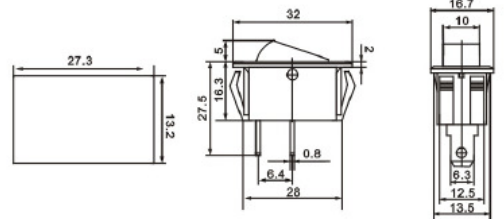

KCD3-201 EN-11C ON-OFF  
DPST 4P

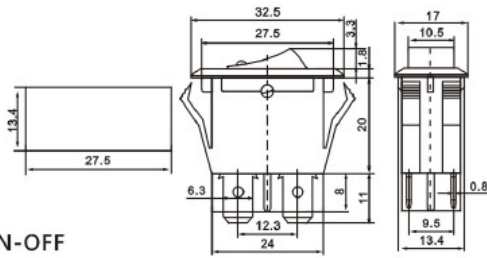

KCD3-101-16

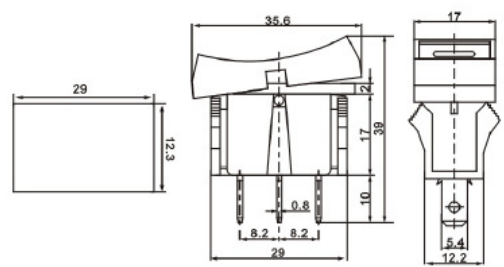

KCD3-101N-12 ON-OFF

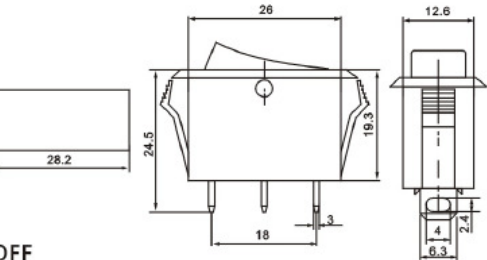

KCD3-101EN-17 ON-OFF

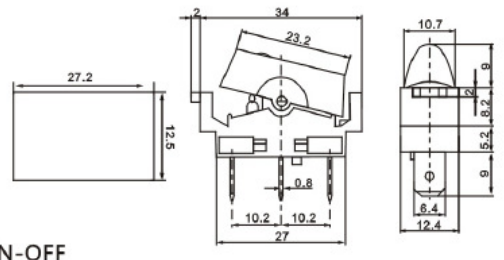

KCD3-101N-13 ON-OFF

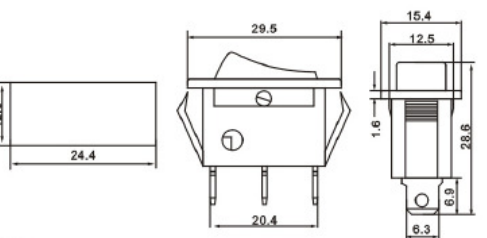

WPC-03  
Waterproof Cover

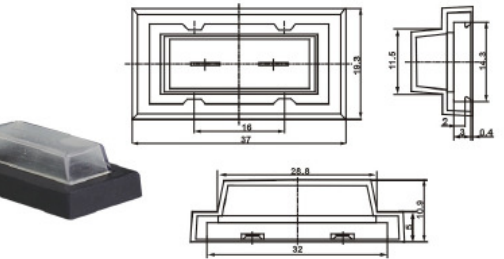

KCD3-201N-14 ON-OFF

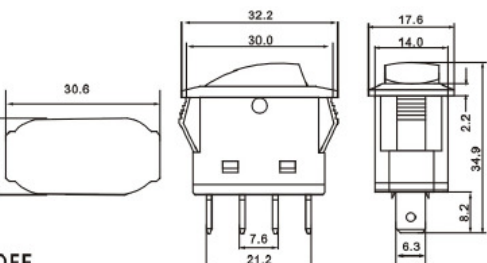

SSC-03  
SWITCH SOCKET

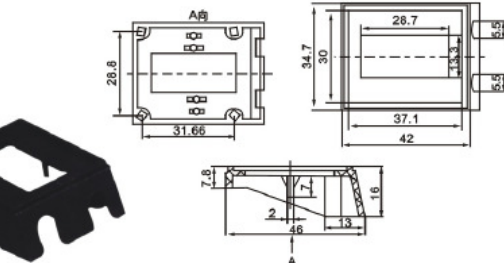



**Model Information**

KCD 2 - 2 01 (E) (N) - 2 C3 - R / B

- Base color
- Cap color
- Cap marking
- Product Number
- Neon lamp
- Dot
- Circuit function
- POLES
- Double-poles
- Rocker Switch

**Specification**

1. Rating: 20A 125VAC; 15A 250VAC; 35A 12VDC
2. Contact Resistance: 35mΩ max
3. Insulation Resistance: 500VDC 100mΩ min
4. Dielectric Strength: 1500VAC, 1minute
5. Operating Temperature: -25°C ~ +85°C
6. Electrical Life: 10'000 Cycles







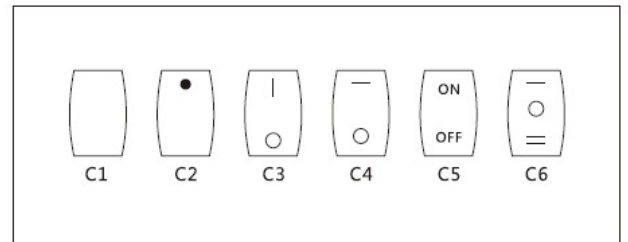

**Circuit function**

01	ON	-	OFF
02	ON	-	ON
11	(ON)		OFF
12	ON	-	(ON)
03	ON	OFF	ON
13	ON	OFF	(ON)
23	(ON)	OFF	(ON)

( ) Indicates Momentary

**Cap marking**



 <p><b>KCD2-201 ON-OFF</b> <b>KCD2-211(ON)-OFF (单复位)</b></p>	 <p><b>KCD2-203N ON-OFF-ON</b></p>
 <p><b>KCD2-201/N ON-OFF</b></p>	 <p><b>KCD2-2101 4P ON-OFF</b> <b>KCD2-2101N ON-OFF</b></p>
 <p><b>KCD2-202 ON-ON</b> <b>KCD2-202/N ON-ON</b></p>	 <p><b>KCD2-2101EN ON-OFF</b></p>
 <p><b>KCD2-203 ON-OFF-ON</b> <b>KCD2-213 (ON)-OFF-ON</b> <b>KCD2-223 (ON)-OFF-(ON) (双复位)</b></p>	 <p><b>KCD2-201-2 ON-OFF</b> <b>KCD2-201N-2 ON-OFF</b></p>

**ROCKER SWITCH**

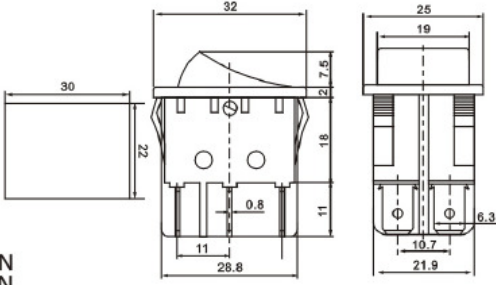

KCD2-202-2 ON-ON  
KCD2-202N-2 ON-ON

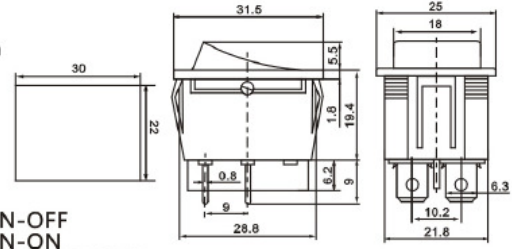

KCD2-201-4 4P ON-OFF  
KCD2-202-4 6P ON-ON  
KCD2-223-4 6P (ON)-OFF-(ON)

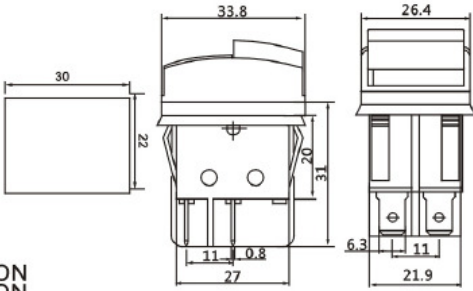

KCD2-202-2P ON-ON  
KCD2-202N-2P ON-ON

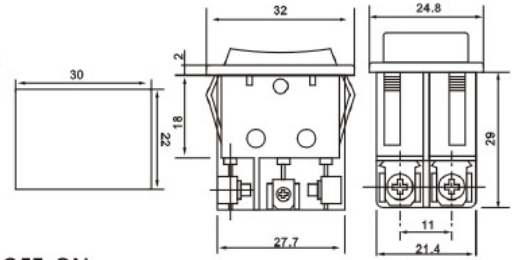

KCD2-203-4S ON-OFF-ON

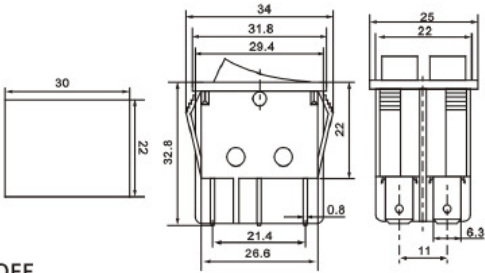

KCD2-2101N-2 ON-OFF

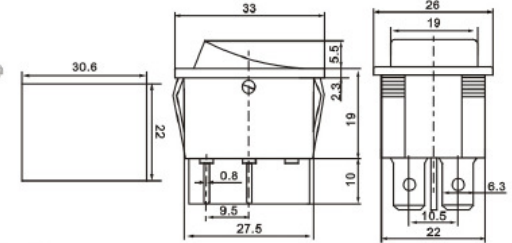

KCD2-201N-4P ON-OFF

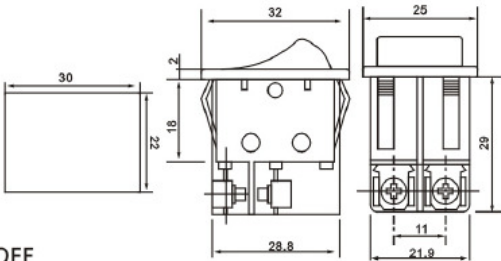

KCD2-201-2S ON-OFF  
KCD2-201N-2S ON-OFF

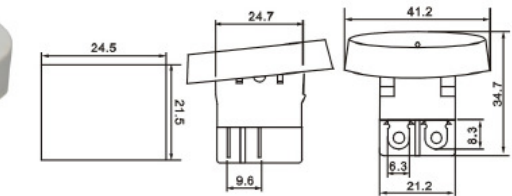

KCD2-201-5 ON-OFF

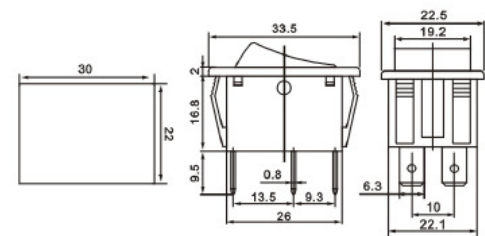

KCD2-203-3 ON-OFF-ON

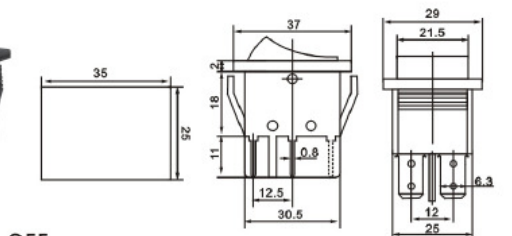

KCD2-201-6 ON-OFF  
KCD2-201N-6 ON-OFF

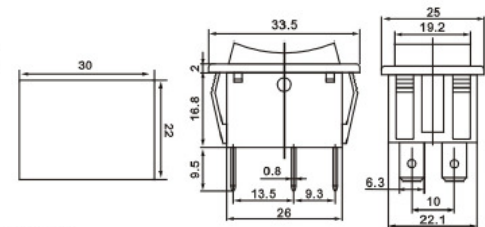

KCD2-213-3 (ON)-OFF-ON  
KCD2-213-3 (ON)-OFF-(ON)

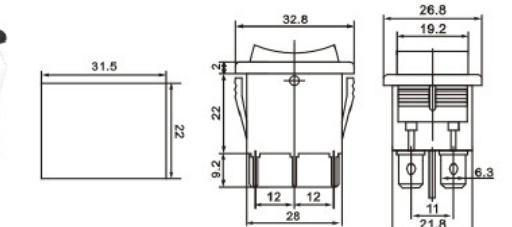

KCD2-223-7 (ON)-OFF-(ON)



# ROCKER SWITCH

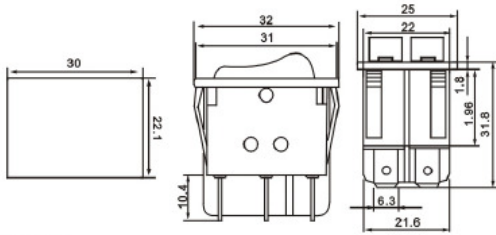

**KCD2-2101EN-2 ON-OFF**

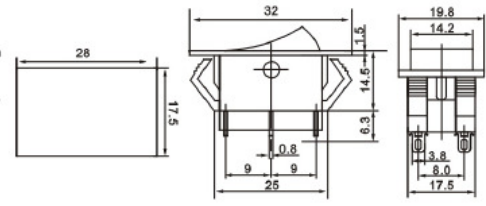

**KCD2-202-8 ON-ON**

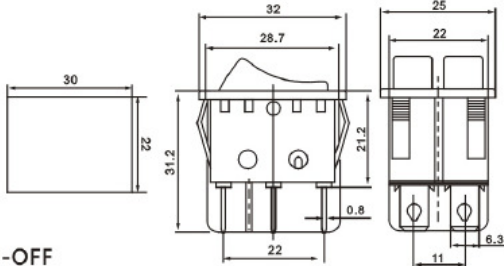

**KCD2-2101-4 ON-OFF**  
**KCD2-2101N-4 ON-OFF**

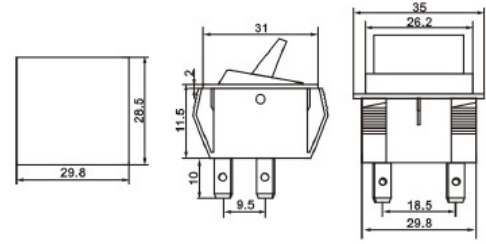

**KCD2-202-9 ON-OFF**

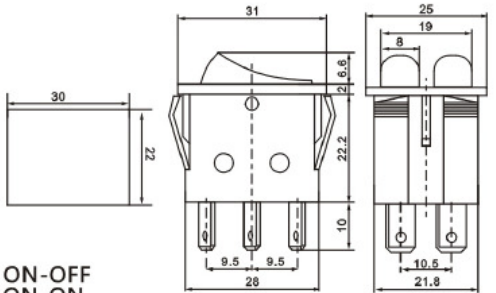

**KCD2-2101-5 4P ON-OFF**  
**KCD2-2101N-5 6P ON-ON**

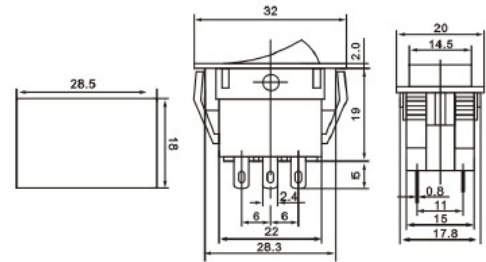

**KNDZ ON-ON**

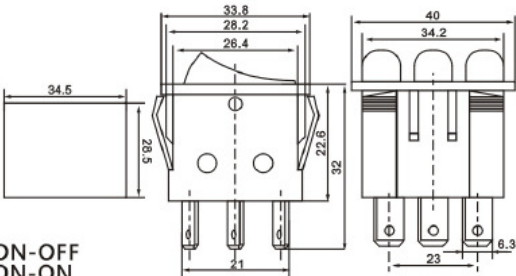

**KCD2-3101 6P ON-OFF**  
**KCD2-3101N 9P ON-ON**

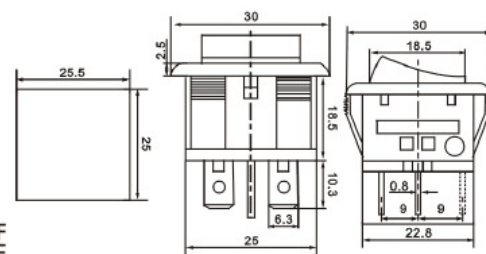

**RK1-05 4P ON-OFF**  
**RK1-05N 4P ON-OFF**  
**RK1-05 6P ON-ON**

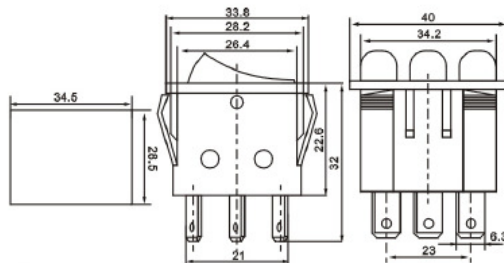

**KCD2-3101N-2 ON-OFF**

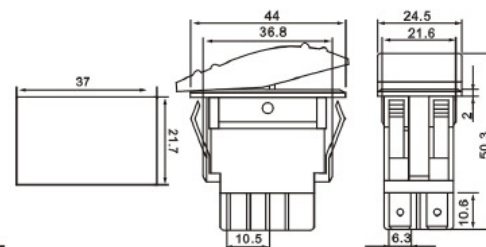

**RK1-06 4P ON-OFF**  
**RK1-06N 4P ON-OFF**

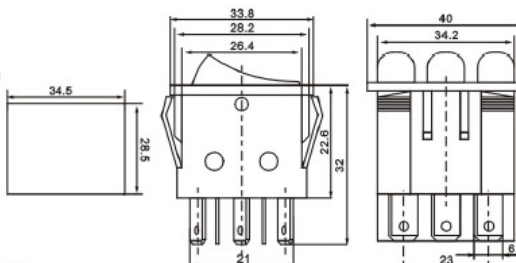

**KCD2-3101N-3 ON-OFF**

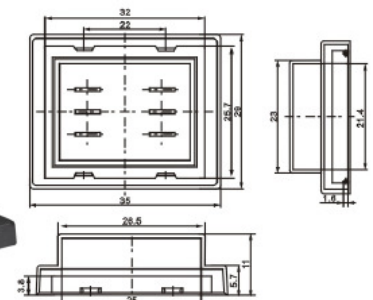

**WPC-04**  
**Waterproof Cover**