

P/N: 5561T

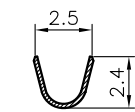

Section A-A

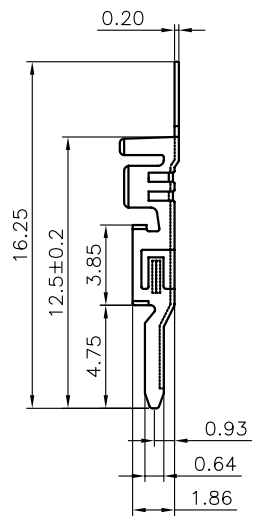
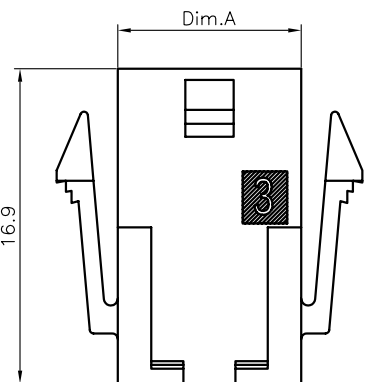
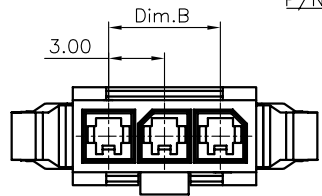
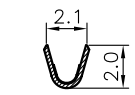

Section B-B

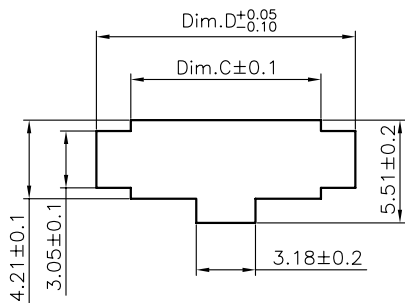

RECOMMENDED PANEL CUT-OUT

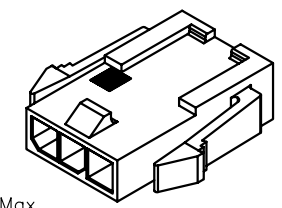

Specifications:

Current Rating:5.0A AC/DC
 Voltage Rating:250V AC/DC
 Contact Resistance:20m ohm. Max.
 Insulation Resistance:1,000M ohm. Min.
 Withstanding Voltage:1,500V AC For One Minute
 Operating Temperature Range:-25°C To +105°C
 Material:Nylon 66 (UL94V-0)
 Contact:Phosphor Bronze
 Plating:Tin Plated
 Application Wire:Awg#24~#20
 How to Order:
 5561A-XX

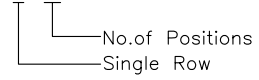

DIMENSION INFORMATION

POSITION	DIM. A	DIM. B	DIM. C	DIM. D
2	6.85	N/A	7.21	10.90
3	9.85	6.00	10.21	13.89
4	12.85	9.00	13.21	16.89
5	15.85	12.00	16.21	19.89
6	18.85	15.00	19.21	22.89
7	21.85	18.00	22.20	25.88
8	24.85	21.00	25.20	28.88
9	27.85	24.00	28.20	31.88
10	30.85	27.00	31.22	34.87
11	33.85	30.00	34.22	37.87
12	36.85	33.00	37.22	40.87

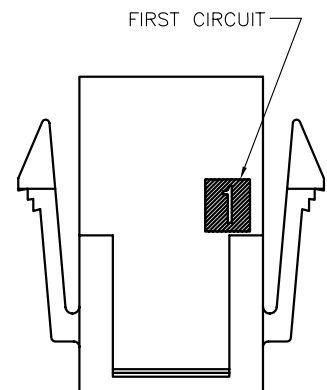

RoHS Compliant



GENERAL TOLERANCE: .X=±0.20 .XX=±0.15		DESCRIPTION: 3.0mm Power Plug Single Row Housing	SIZE A4
UNIT: MM	PART NO: 5561A-XX		
SCALE: 1:1			
SHEET: 1 / 2			
PROJECTION:			

1

2

3

4

5

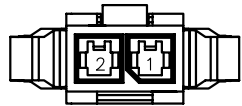

2PIN

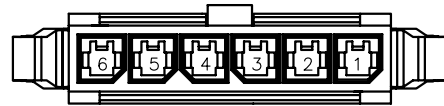

6PIN

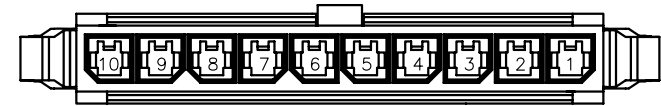

10PIN

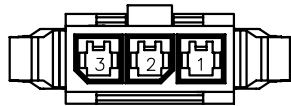

3PIN

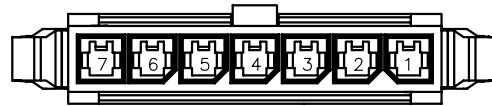

7PIN

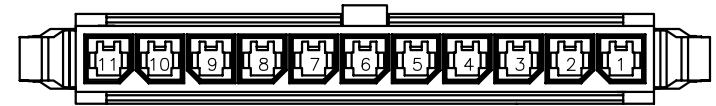

11PIN

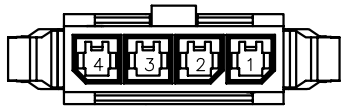

4PIN

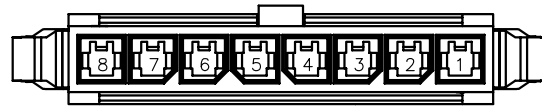

8PIN

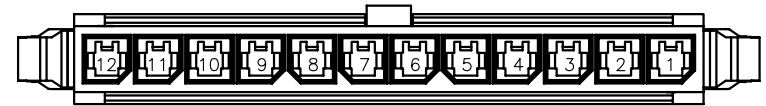

12PIN

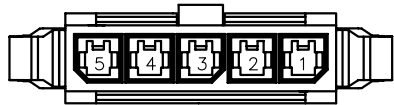

5PIN

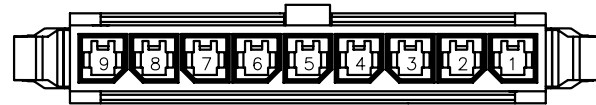

9PIN

2~12PIN防呆圖

RoHS Compliant

GENERAL TOLERANCE:
 .X=±0.20
 .XX=±0.15

UNIT: MM

SCALE: 1:1

SHEET: 2 / 2

PROJECTION:

DESCRIPTION:
 3.0mm Power Plug Single Row Housing

PART NO:
 5561A-XX

SIZE
A4

A

B

C

D