

Position	A	B	C	D
6P	7.62	5.08	10.16	7.62
8P	10.16	7.62	10.16	7.62
14P	17.82	15.24	10.16	7.62
16P	20.32	17.78	10.16	7.62
18P	22.86	20.32	10.16	7.62
20P	25.40	22.86	10.16	7.62
24P	30.48	27.94	10.16	7.62
28P	35.56	33.02	10.16	7.62

Position	A	B	C	D
24P	30.48	27.94	17.78	15.24
28P	35.56	33.02	17.78	15.24
40P	50.80	48.26	17.78	15.24

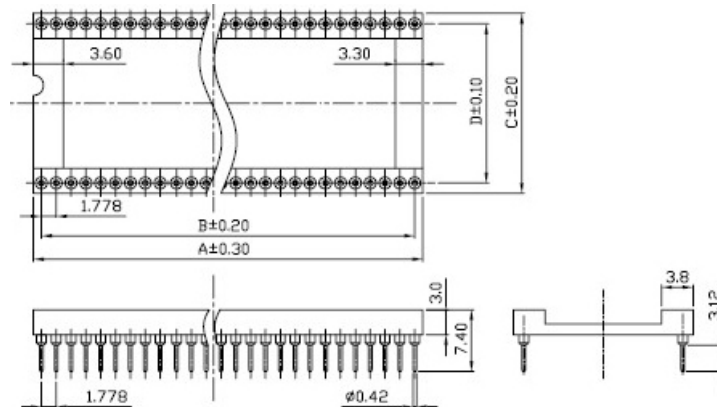

Position	A	B	C	D
24P	21.46	19.56	12.65	10.16
28P	25.01	23.11	12.65	10.16
42P	37.46	35.56	17.73	15.24
48P	42.79	40.89	17.73	15.24
52P	46.35	44.45	17.73	15.24
56P	49.91	48.01	17.73	25.24
64P	57.04	55.12	21.54	19.05

How to Order:

SCSM - 2.54 - A      10 - \_\_\_\_\_  
 Series No.      Pitch(mm)   " D " Type Option      Poles      Customer Request

2.54      A: 7.62mm  
 1.778      B: 15.24mm ( " D " Type option just valid for 2.54mm Pitch items )